



Owner Manual

Matrix Dry-Break Quick Couplers

MATRIX



N340/N340p
R340/R340c

N330/N330p
R330/R330c

N320/N320p
R320/R320c

N310/N310p
R310/R310c



N350/N350p
R350/R350c

N360/N360p
R360/R360c

N370/N370p
R370/R370c

N380/N380p
R380/R380c

Operating Pressure

-All Couplers

1500 psi

Burst Pressure

-All Couplers

4500 psi

Operating Temperature

-All couplers

-35°F to 250°F

Flow Area

-All Couplers

Approx. .4400 sq. in.

Thread Sizes

-All Nozzles

3/4" Female NPT

-All Receivers

3/4" Male NPT

- Series of eight nozzles will only inter-lock with color-coordinated receiver.

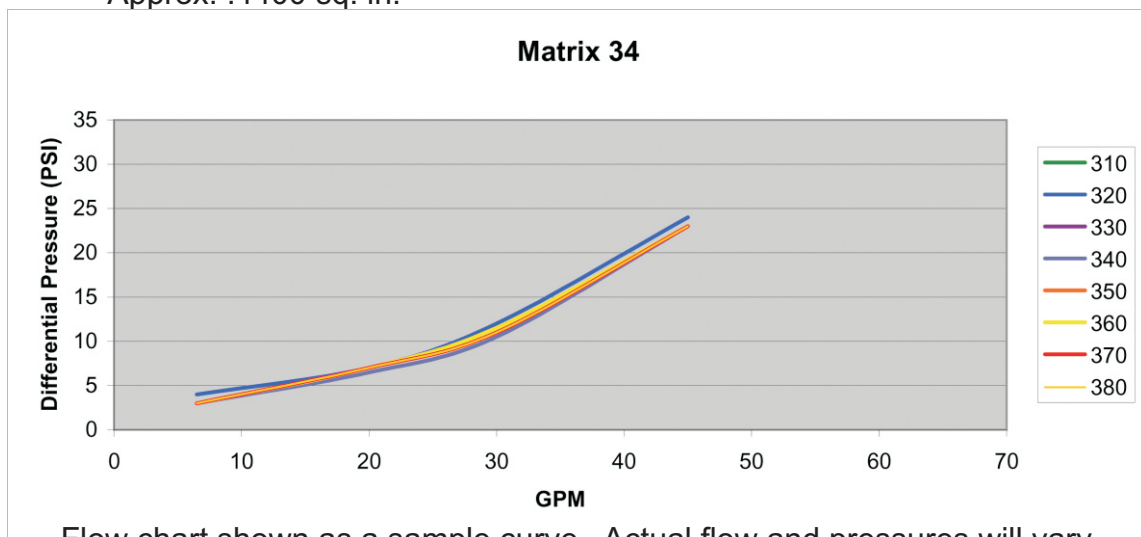

Flow chart shown as a sample curve. Actual flow and pressures will vary depending on fluid used.



Owner Manual

Matrix Dry-Break Quick Couplers

N310 - N380

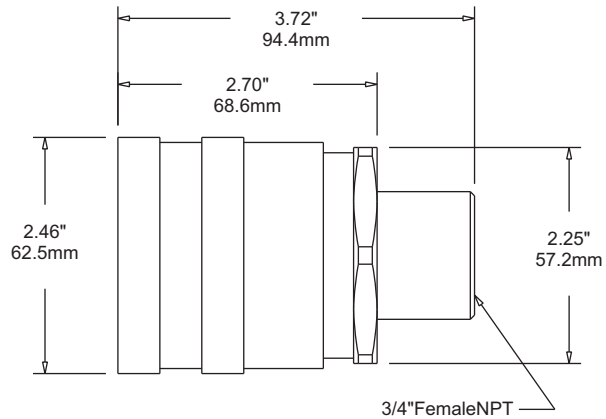
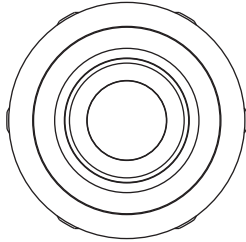

R310 - R380

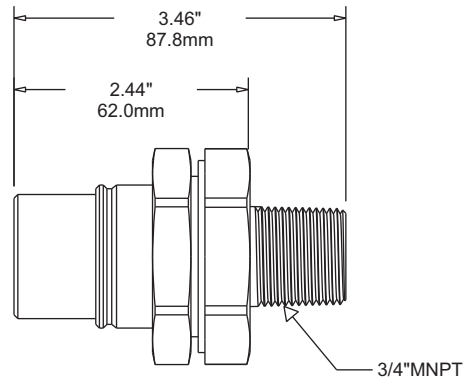
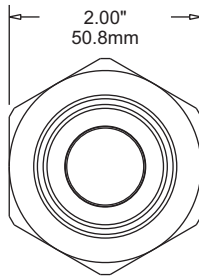

P310 - P380

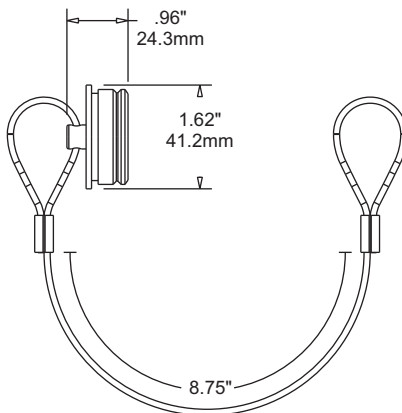

C310 - C380

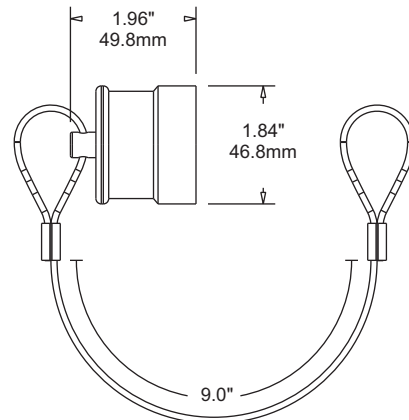



Owner Manual

Matrix Dry-Break Quick Couplers

200 Series Matrix Nozzles

A slimmed down version of our Matrix series of dry-break nozzle. The Matrix 200 nozzles are a direct cross-over from the Matrix 34 and mate with the corresponding color-coded Matrix 34 receiver. They offer the same cross-contamination protection in a slimmed down, lighter version.

Operating Pressure

-All Couplers

1500 psi

Burst Pressure

-All Couplers

4500 psi

Flow Area

-All Couplers

Approx. .4400 sq. in.

Thread Sizes

-All Nozzles

3/4" Female NPT

N210 - N280

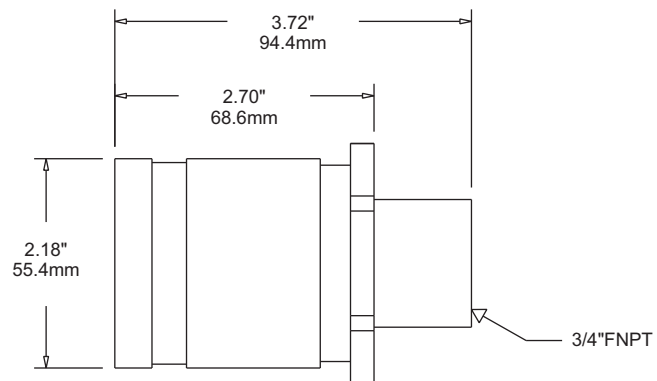
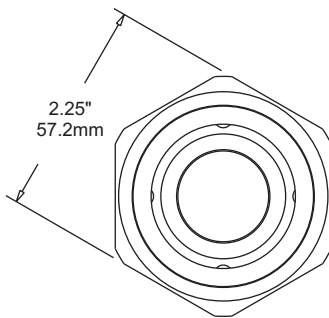



Owner Manual

Matrix Dry-Break Quick Couplers

Evacuation

The ET290 is a universal evacuation solution for the matrix dry-break coupler line. It has been designed to accommodate all Matrix receivers and has an integrated internal check-valve to allow fluid evacuation only.

The EPK390 has been designed to fit all fluid evacuation ports on Komatsu equipment with the exception of the WA800 and Wa900 transmission ports.

Operating Pressure

-All Couplers

1500 psi

Burst Pressure

-All Couplers

4500 psi

Flow Area

-All Couplers

Approx. .4400 sq. in.

Thread Sizes

-ET290

3/4" Female NPT

-ET290J

-16 JIC

-EPK390

M24 1.5mm Pitch

ET290

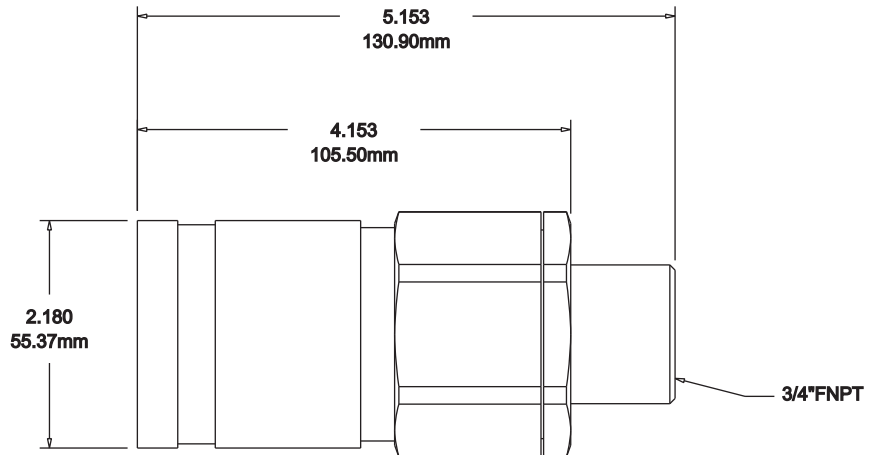
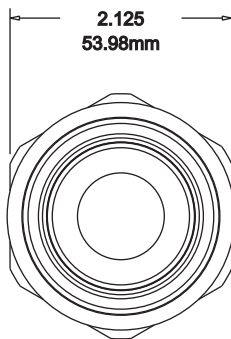

ET290J

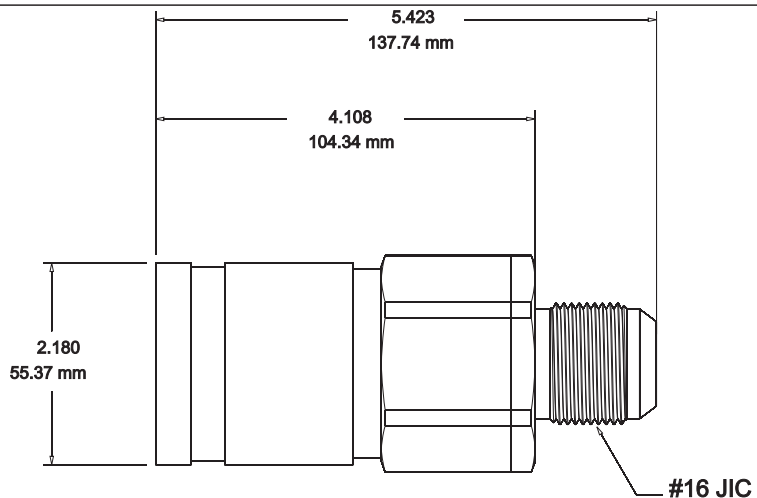
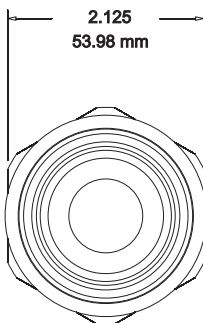



Owner Manual

Matrix Dry-Break Quick Couplers

Evacuation

EPK390

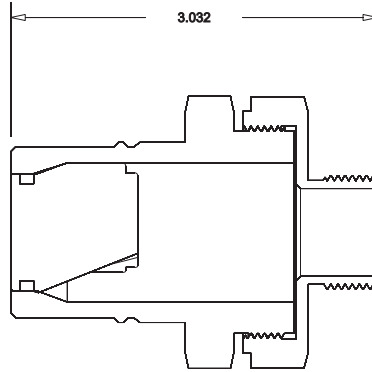
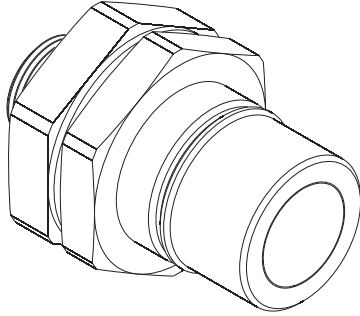

Section A-A

